

Extreme Material-Handling Challenges - Require **EXTREME** Components!

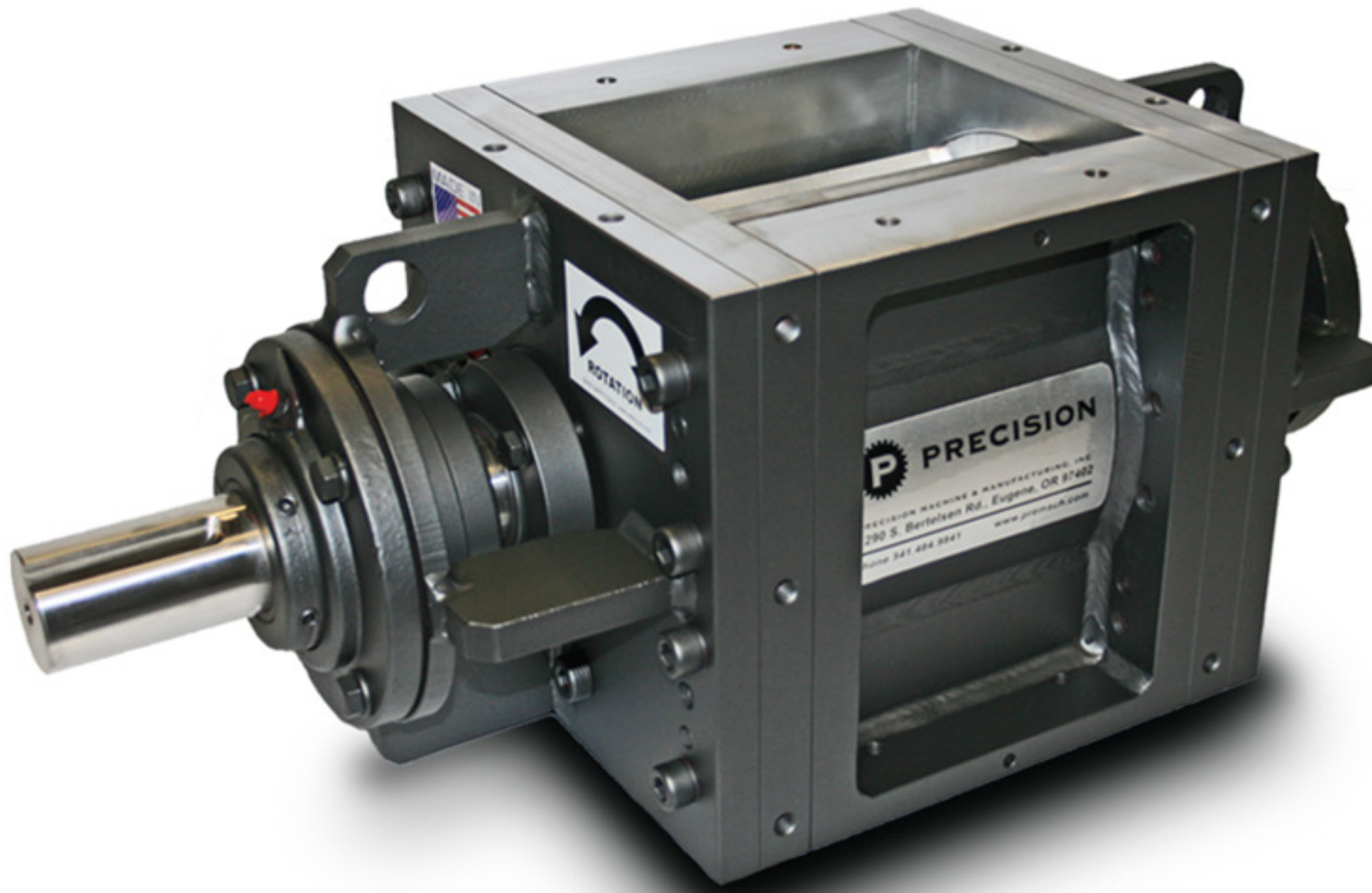

PRECISION
MACHINE & MANUFACTURING



MODULAR ROTARY VALVE

Maximum **functionality**
& **durability** in a single
rebuildable rotary valve.



“Superior return on Investment”



Rotary Feeders • Rotary Valves • Screw Conveyors



The Only Fully Machined Rotary Valve In The World!

When it comes to metering minerals and/or powdery materials, such as Calcium Carbonate, Titanium Dioxide, and/or Talc to name a few, the modular rotary valve is hands-down the most effective option! Made from a specially formulated and domestically sourced abrasion resistant alloy, the Precision Rotary Valve offers superior functionality and durability! The only rebuildable, heavy-duty metering airlock in the world!

MODULAR ROTARY VALVE

What Makes the Rotary Valve Work

Wear Plates

Replaceable wear plates protect the end bells and keep a tight tolerance around the rotor end.

End Bells

Precisely machined to maximize functionality and equipped with ultra-duty bearings to ensure superior functionality and durability!

Barrel Sides

Except for the rotor, the barrel sides are the most subjective to wear. With this in mind, we manufacture all barrel sides from the most durable, abrasion-resistant alloy we can domestically source. With a **through-hardness** rating of 50 Rockwell, there is not a stronger rotary valve in the industry.

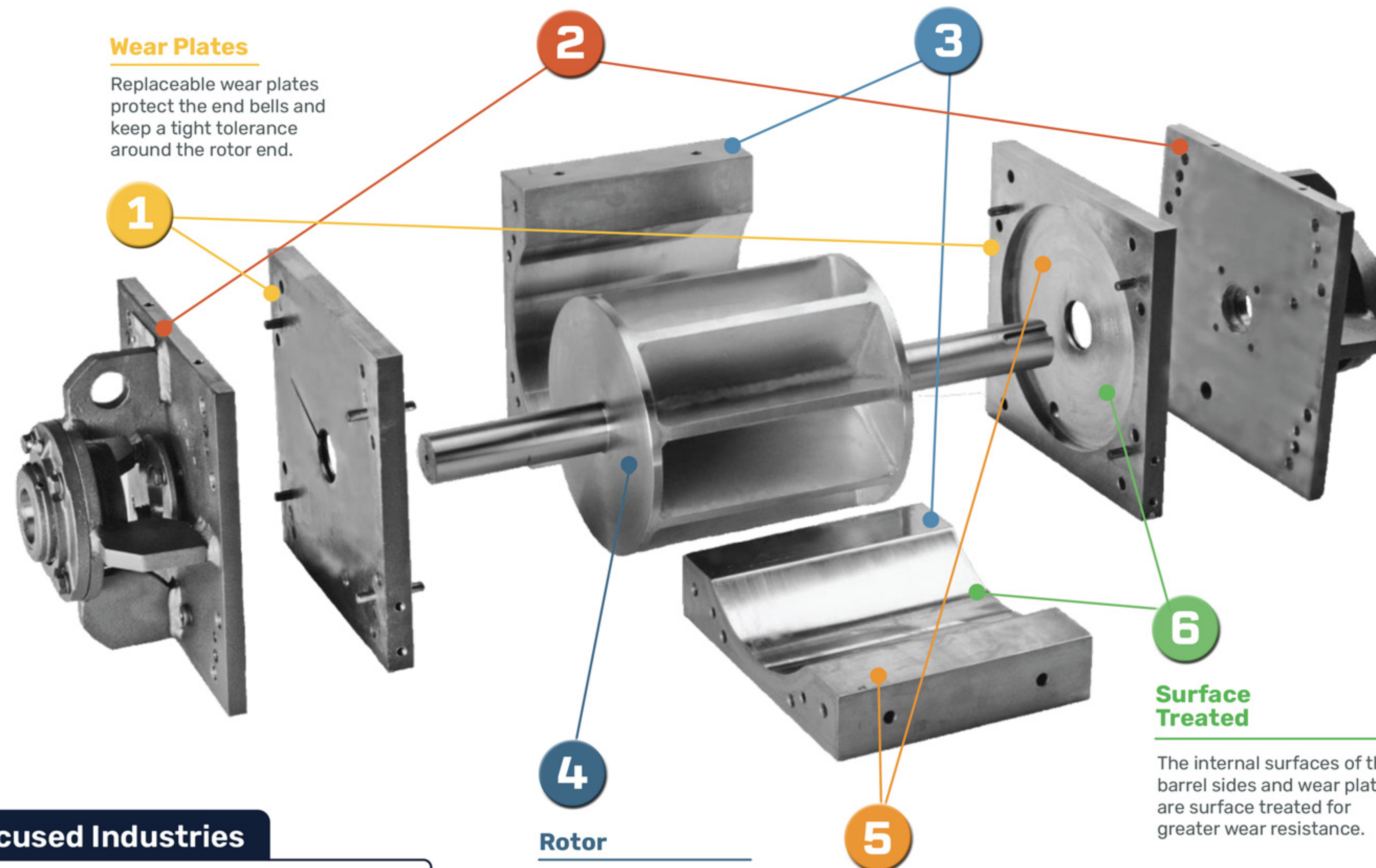

Focused Industries



Rotor

Made from a specially sourced 500 Brinell abrasion resistant alloy, this eight-pocket, closed-ended, rotor keeps the material flowing.

Super-Tight Tolerances

The only fully machined rotary valve in the world! PMM's manufacturing standards allows our valves to achieve +/- 0.001" tolerance, which maximizes the airlock functionality!

Surface Treated

The internal surfaces of the barrel sides and wear plates are surface treated for greater wear resistance.

Modular Design

The modular design makes assembly and disassembly a breeze! Because our rotary valves are manufactured to simplify the repair and rebuild process, wear items can be easily replaced during a scheduled outage, which minimizes production downtime and cost.

No other rotary valve offers this level of functionality and durability in a rebuildable unit!

MODULAR ROTARY VALVE Key Advantages

- ✓ **THERE IS A BETTER OPTION!**
Eliminate those problematic, air-leaking, maintenance heavy, cast iron feeders with our superior performing rotary valve.
- ✓ Functional reliability avoids costly unscheduled downtime! Outage-to-Outage durability allows maintenance to be preplanned, which eliminates costly emergency shutdowns.
- ✓ Compact design is a "universal replacement" for competing models, which minimizes retrofitting.
- ✓ Tolerances are precisely machined to minimize air leakage and material blow-by.
- ✓ Modular design makes repairs simple! Due to the modularity and rebuild capability, Precision's Rotary Valve continues to provide a positive return on initial investment (ROI) for many years to come!

Precision Machine & Manufacturing's components are precisely crafted from raw materials that are made right here in the United States of America!

Quality you can count on!



 premach.com

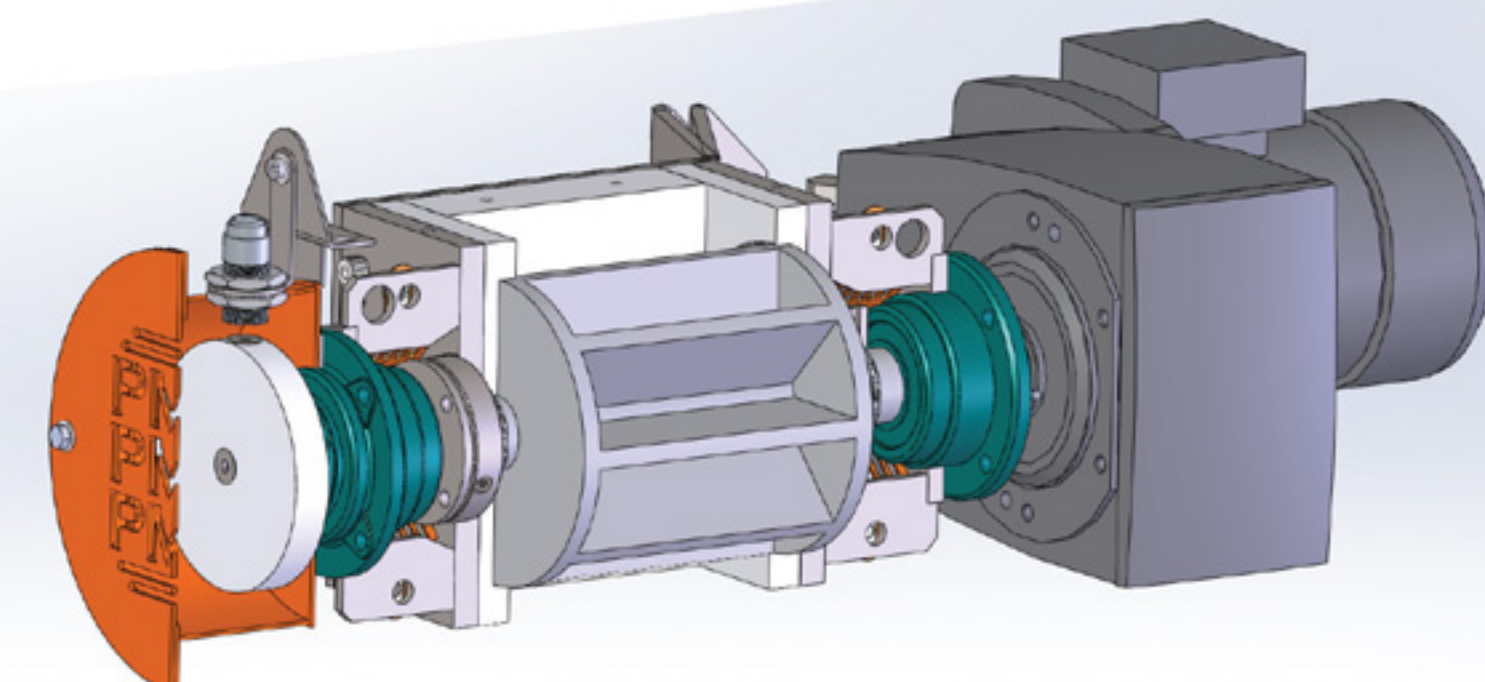

**Choose the right size for
your unique material
handling application.**

SEVERE-DUTY

Severe-Duty Rotary Valves are our standard rotary valves and the perfect solution when moving minerals, aggregates and other powdery, abrasive, corrosive, and high-temperature material types.

ULTRA-DUTY

Ultra-Duty Rotary Valves are for the most challenging material types! Ultra-Duty Rotary Valves are surface treated with ion-ni-tride to provide greater abrasion resistance and wear protection from the harshest materials.

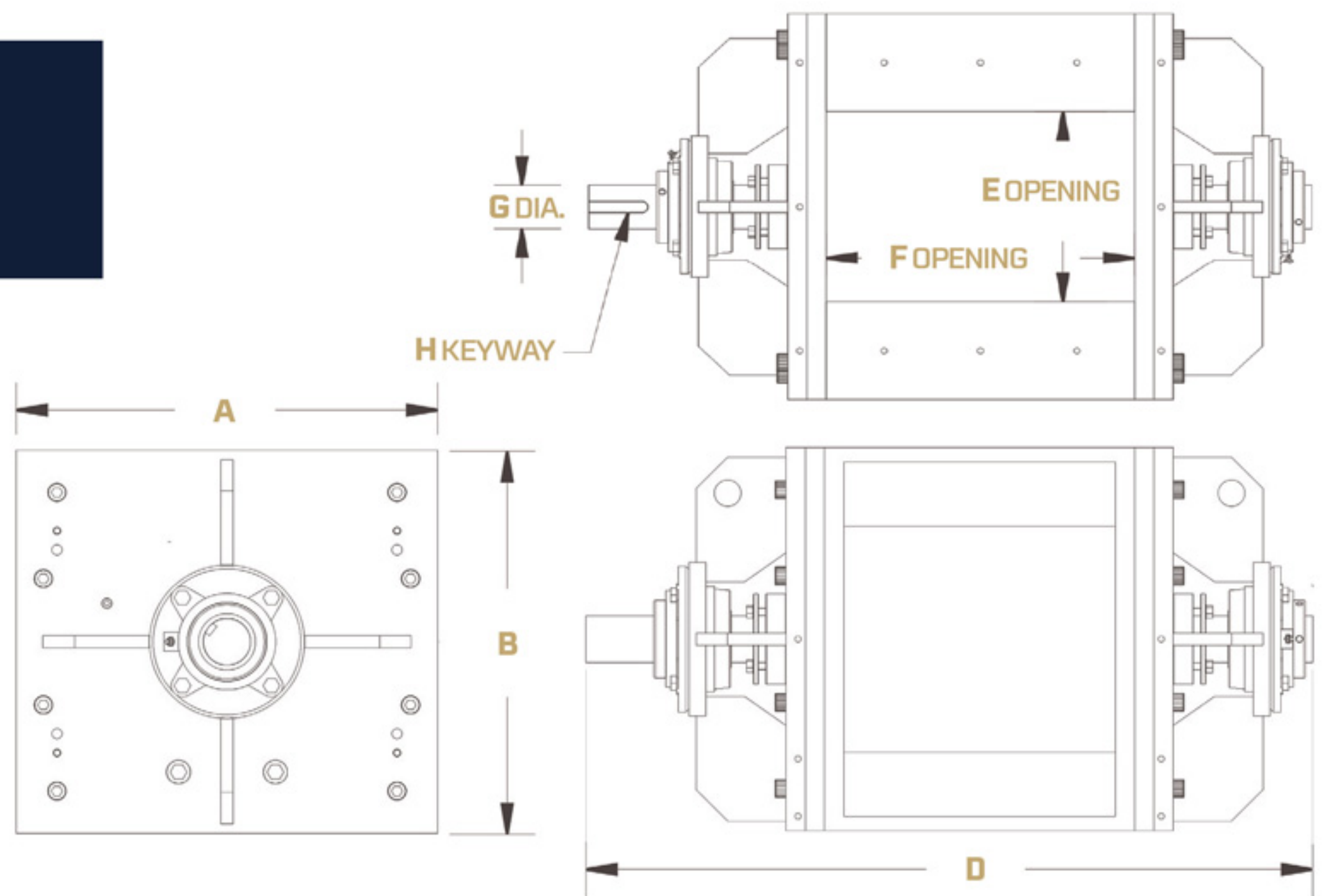

SIZE	CAPACITY		DIMENSIONS [inches]					
	CFR	A	B	C	D	E	F	G
PMV-8	0.17	11.00	10.00	11.40	25.75	6.50	8.00	1.94
PMV-10	0.34	12.00	12.00	13.40	27.75	7.00	10.00	1.94
PMV-12	0.62	15.00	15.00	15.40	29.75	9.00	12.00	1.94
PMV-14	1.00	18.00	17.00	18.00	35.50	9.62	14.00	2.44
PMV-16	1.60	21.75	20.00	20.00	37.50	10.75	16.00	2.44
PMV-18	2.25	24.00	22.00	22.00	40.75	18.00	18.00	2.94
PMV-20	3.10	26.00	24.00	24.00	42.75	20.38	20.00	2.94
PMV-22	4.00	28.00	26.00	26.25	47.25	22.00	22.00	2.94
PMV-24	5.14	32.00	29.00	28.25	51.13	23.57	24.00	3.44
PMV-26	6.95	36.00	32.00	30.50	55.00	26.00	26.00	3.44
PMV-28	8.78	38.00	34.00	32.50	57.00	28.00	28.00	3.94

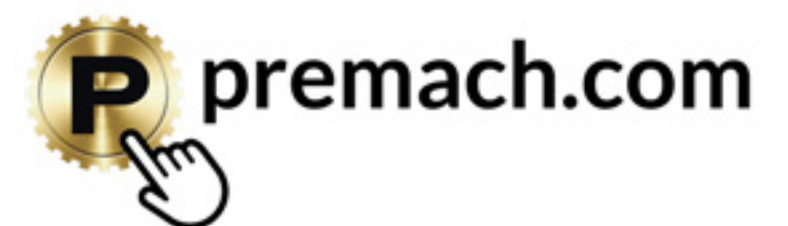

**CONTACT
PRECISION
TODAY**

For more information.

541-484-9841
sales@premach.com



PRECISION
MACHINE & MANUFACTURING

1290 S. Bertelsen Road, Eugene, OR 97402